

# COMMERCIAL





Since 1987, Madero has provided expertise in the fabrication and distribution of commercial door and hardware systems.

Our team is available to provide complete solutions to the challenges of today's door and hardware industry.



# COMMERCIAL

<b>RETAIL MERCHANDISER PROGRAM</b>	<b>4-20</b>
<b>STEP 1: EXPANDABLE JAMB KIT</b>	<b>4</b>
Frame Options	5-7
<b>STEP 2: HOLLOW METAL DOORS</b>	<b>8</b>
Door Options	9-11
<b>STEP 3: CHOOSE HARDWARE</b>	<b>12-18</b>
Hardware Options	19
<b>STEP 4: WEATHERSEALS &amp; SILL KIT</b>	<b>20</b>
<b>WEST FOUR ALUMINUM</b>	<b>21</b>
<b>BUILDING SPECIALTIES</b>	<b>22-25</b>
<b>CHECKLIST</b>	<b>27</b>

# STEP 1: EXPANDABLE JAMB KIT - RETAIL PROGRAM

## EXPANDABLE JAMB KIT - RETAIL PROGRAM

Expandable frames are an ideal solution for commercial building applications and retrofit work on existing buildings, specifically when existing wall types are unknown or vary throughout the project.



Fire rated from 45 up to 90 minutes



### KIT INCLUDES:

#### Jamb Set

3 pieces: header, hinge jamb and single strike jamb. 18 gauge, square corner.  
Expandable from 4-1/2" to 7-7/8"  
Reversible (6/8), Handed (7/0).  
Width as noted: 2/8 (31-3/4"), 3/0 (35-3/4")

#### Hinges (3 included)

4-1/2"x4" ball bearing, square corners, non-removable pin, Satin Chrome 26D finish

#### Finishing

Galvanneal steel is matte grey and ready for the finish paint - primer is not required.

#### Expandable Slide Bracket

These brackets are manufactured from 16 gauge galvanneal steel which are spot welded to the frame material. Three sliders are used on frame jambs and two sliders are used on frame heads to allow for smooth operation.

#### Reinforcements

Reinforcements are welded to the frame for three hinges and strike placement. The strike jamb leg is prepped for a 4-7/8" ANSI strike. Closer reinforcement is 12 gauge and welded to the header.

### HOW TO INSTALL AN EXPANDABLE FRAME

Frame jambs have corner tabs spot welded at the seam which interlock with slots on the frame head. This product is then bent over to pull the corners at the head and jamb legs, creating a tight joint.

The frame faces are dimpled in three locations on the jambs and two locations on the heads, allowing for screw fastening of the frame to the wall.

Bondo screw holes after installation, before painting.

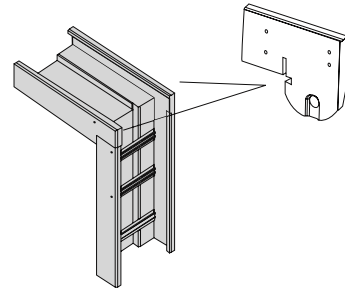

CODES	LIMITED DESCRIPTION	NOMINAL DOOR SIZE	ACTUAL DOOR SIZE	ROUGH OPENING	SWING
Q-XF2/8X6/8	Expandable Frame Kit for 2/8x6/8 Door (incl. NRP Hinges)	2/8 x 6/8	31-3/4" x 79-1/8"	33-3/4" x 81"	Reversible
Q-XF2/8X7/0L	Expandable Frame Kit for 2/8x7/0 LH Door (incl. NRP Hinges)	2/8 x 7/0	31-3/4" x 83-1/8"	33-3/4" x 85"	Left Handed
Q-XF2/8X7/0R	Expandable Frame Kit for 2/8x7/0 RH Door (incl. NRP Hinges)	2/8 x 7/0	31-3/4" x 83-1/8"	33-3/4" x 85"	Right Handed
Q-XF3/0X6/8	Expandable Frame Kit for 3/0x6/8 Door (incl. NRP Hinges)	3/0 x 6/8	35-3/4" x 79-1/8"	37-3/4" x 81"	Reversible
Q-XF3/0X7/0L	Expandable Frame Kit for 3/0x7/0 LH Door (incl. NRP Hinges)	3/0 x 7/0	35-3/4" x 83-1/8"	37-3/4" x 85"	Left Handed
Q-XF3/0X7/0R	Expandable Frame Kit for 3/0x7/0 RH Door (incl. NRP Hinges)	3/0 x 7/0	35-3/4" x 83-1/8"	37-3/4" x 85"	Right Handed

## LARGE EXPANDABLE SQUARE CORNER 16 GAUGE

Adjustable frames provide the ultimate versatility for use in drywall applications or masonry butt applications as this frame can be adjusted to fit a wide range of wall thicknesses from 7-5/8" to 12-1/2".

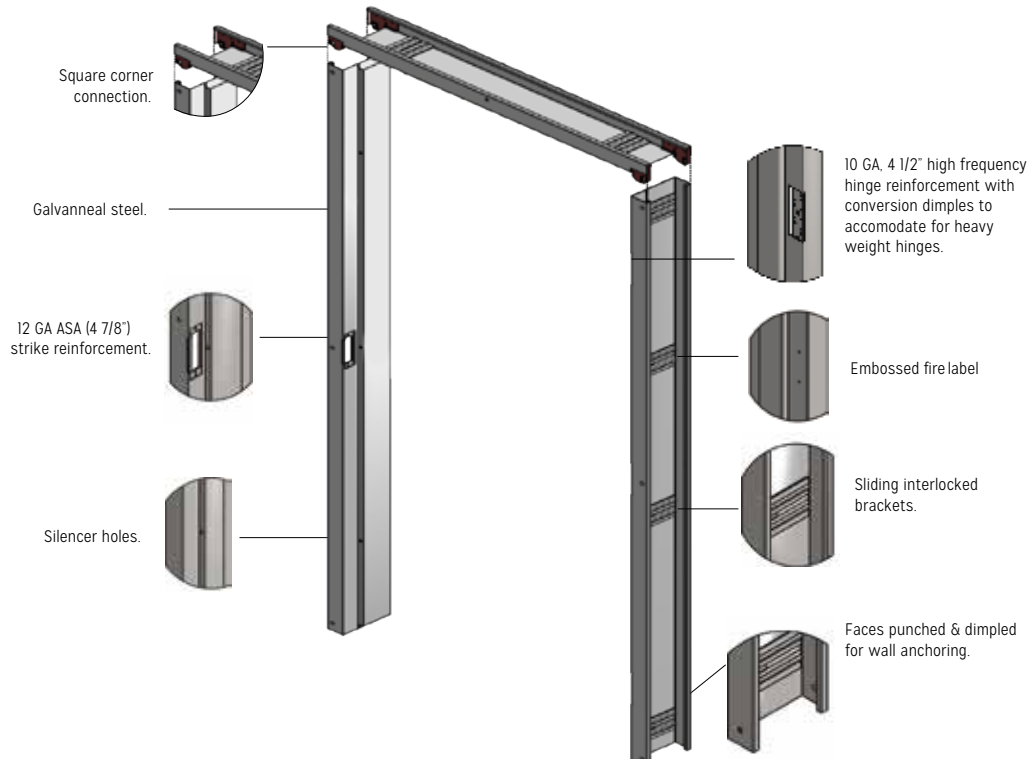

## EXPANDABLE EF FRAME SERIES (NON-REVERSIBLE)

### EF MITRED CORNER - 16 GA. STEEL

EF Series frames are designed to accommodate the broadest range of wall construction with a single adjustable product. EF Series features a two piece frame component, held together with a bracket system and spot welded to the frame material, allowing the jamb depth to be reduced or increased based on site conditions.

NOMINAL DOOR SIZE	ACTUAL DOOR SIZE	ROUGH OPENING	SWING
2/8 x 6/8	31-3/4" x 79-1/8"	33-3/4" x 81"	Handed
3/0 x 6/8	35-3/4" x 79-1/8"	37-3/4" x 81"	Handed
2/8 x 7/0	31-3/4" x 83-1/8"	33-3/4" x 85"	Handed
3/0 x 7/0	35-3/4" x 83-1/8"	37-3/4" x 85"	Handed

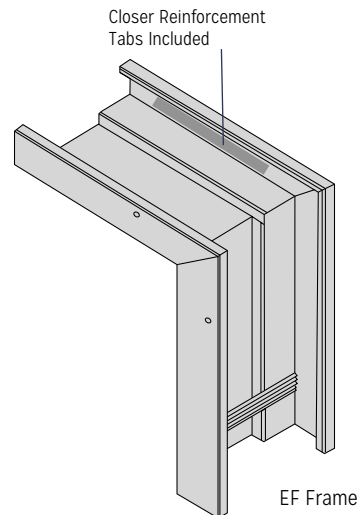

- EF-1 (Special Order) Expandable from 3-1/2" to 5-1/4" wall thickness
- EF-2 Expandable from 5-3/8" to 8-11/16" wall thickness
- EF-3 Expandable from 8-11/16" to 12" wall thickness
- Fire Rating 20 to 90 minute



## DRYWALL FRAMES (DW)

**NOTE:** For 1-3/4" door thickness.

One person can install Daybar drywall frames quickly and efficiently

**Usage:** Interior – commercial or industrial.

### Installation

Drywall frames are supplied in three pieces and are installed after the framing stage. Jambs have corner tabs spot welded at the mitre, interlocking with slots on the frame head. This tab is then bent over to make a tight joint. Each jamb has a dimpled base anchor for fastening to the floor plate and tension anchor at the top.

### Reinforcements

Reinforcements are welded to the frame for three hinges and strike placement. The strike jamb leg is prepped for a 4-7/8" ANSI strike.

Fire Rating	20 to 90 minute 
Rough Opening	Width = Nominal door width plus 2" Height = Nominal door height plus 1-1/4"
Finishing	Galvanneal steel is matte grey and ready for the finish paint - primer is not required

MODEL	JAMB DEPTH	THROAT*
350K	4-1/2" (114mm)	3-1/2" (89mm) <i>Special Order</i>
462K	5-5/8" (143mm)	4-5/8" (118mm)
487K	5-7/8" (149mm)	4-7/8" (124mm)
525K	6-1/4" (159mm)	5-1/4" (133mm) <i>Special Order</i>
675K	7-3/4" (197mm)	6-3/4" (172mm) <i>Special Order</i>
725K	8-1/4" (210mm)	7-1/4" (184mm) <i>Special Order</i>

\* Throat size should match wall thickness. It is common for throat sizes to exceed wall thickness by 1/8". Caulking is used to fill any additional spacing.

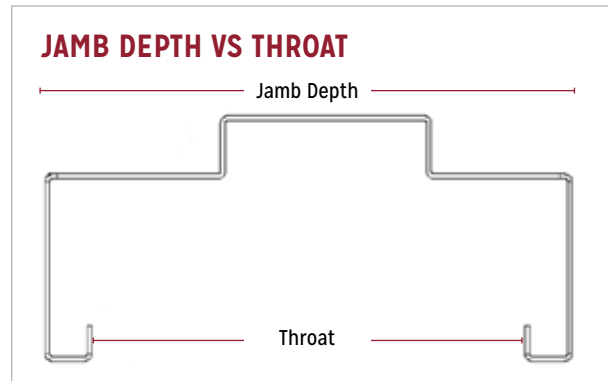

## HOLLOW METAL WELDED FRAMES

**Usage:** Interior or exterior – residential, commercial or industrial.

### Single opening

16 gauge galvanized steel is fully welded across the visible side of both faces. Exposed welds are ground, finished and prime painted. Each frame will have two spreader bars tack welded in place and are to be removed before installation. The spreader bars are used to square the frame and keep it stable during shipping to site.

Fire Rating	Up to 180 minute
Rough Opening	Width = Nominal door width plus 4-1/4" Height = Nominal door height plus 2-1/4"
Finishing	Galvanized steel is matte grey and ready for the finish paint - primer is not required

MODEL	JAMB DEPTH	THROAT*
AS 4-3/4"	4-3/4" (121mm)	3-3/4" (95mm)
AS 5-3/4"	5-3/4" (146mm)	4-3/4" (121mm)
AS 6-3/4"	6-3/4" (172mm)	5-3/4" (146mm)
AS 8-3/4"	8-3/4" (222mm)	7-3/4" (196mm)

\* Throat size should match wall thickness. It is common for throat sizes to exceed wall thickness by 1/8". Caulking is used to fill any additional spacing.

### Hinge & Strike Preparation

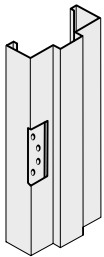

4-1/2" (114) hinge preparation - 10GA. (3.4) reinforced with dust box.

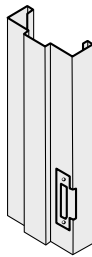

4-7/8" (124) strike preparation [ANSI A115.1] - 14GA. (2.0) reinforced dust box.



### Wall Anchor styles

Fully welded frames are designed to be installed during wall construction and come with welded base angles on each jamb for securing to the floor. Each frame is supplied with masonry, wood stud anchors or steel stud anchors as required.

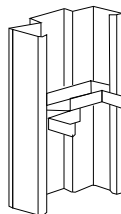

Adjustable stud anchor

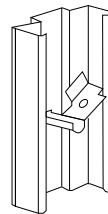

Existing masonry anchor

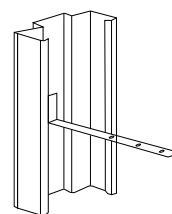

Masonry strap anchor

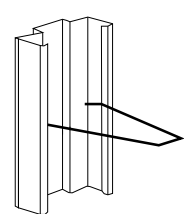

Masonry wire anchor

# STEP 2: HOLLOW METAL DOORS - RETAIL PROGRAM

## HOLLOW METAL DOORS

20 gauge hollow metal doors are designed for commercial buildings, outbuildings and fire rated residential applications.

Galvanneal steel doors are available with two core options; honeycomb core for interior use, or insulated with polystyrene for exterior applications. Polyurethane insulated doors are available for specific applications and sound transmission control.

### 20 GA. LOCKSEAM STEEL DOOR 1-3/4"

Lock seam and beveled edges mechanically interlocking seams on door edges only.

**Closer Reinforcement:** 14 ga. closer reinforcement, fitted to 16 ga. inverted top channel

**Hinge Reinforcement:** 7 ga. hinge reinforcement; to accept (3) 4-1/2" hinges

**Lock Preparation:** ANSI 161 lock reinforcement; 14 ga. prepared for 2-3/4" backset. Beveled to 1/8" or 2 degree bevel

**Size Specifications:** 6/8 reversible doors will accommodate inswing, outswing, left hand or right hand. 7/0 doors require handing and accommodate inswing or outswing.

**Finishing:** Primer not required. Galvanneal steel is matte grey and ready for the finish paint

### CORE OPTIONS:

#### Honeycomb Core (HM)

Usages: Interior, fire rated

Specs: R Value 2.5, STC 32

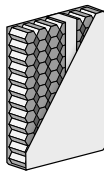

#### Polystyrene (HMIS)

Usages: Exterior, sound

Specs: R Value 6.6, STC 34

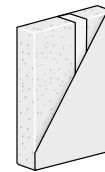

NON-INSULATED	
Q-HM 2/8X6/8	LS20 31 3/4 79 1/8-161 DOOR
Q-HM 2/8X7/0L	LS20 31 3/4 83 1/8-161 DOOR
Q-HM 2/8X7/0R	LS20 31 3/4 83 1/8-161 DOOR
Q-HM 3/0X6/8	LS20 35 3/4 79 1/8-161 DOOR
Q-HM 3/0X7/0L	LS20 35 3/4 83 1/8-161 DOOR
Q-HM 3/0X7/0R	LS20 35 3/4 83 1/8-161 DOOR

INSULATED	
Q-HMIS20 2/8X6/8L DB	LS20 31 3/4 79 1/8-161 DD LH
Q-HMIS20 2/8X6/8R DB	LS20 31 3/4 79 1/8-161 DD RH
Q-HMIS20 2/8X7/0L	LS20 31 3/4 83 1/8-161 LH DOOR
Q-HMIS20 2/8X7/0L DB	LS20 31 3/4 83 1/8-161 DD LH
Q-HMIS20 2/8X7/0R	LS20 31 3/4 83 1/8-161 RH DOOR
Q-HMIS20 2/8X7/0R DB	LS20 31 3/4 83 1/8-161 DD RH
Q-HMIS20 3/0X6/8	LS20 35 3/4 79 1/8-161 DOOR
Q-HMIS20 3/0X6/8L DB	LS20 35 3/4 79 1/8-161 DD LH
Q-HMIS20 3/0X6/8R DB	LS20 35 3/4 79 1/8-161 DD RH

### HINGE PLACEMENT:

#### 6/8 Template

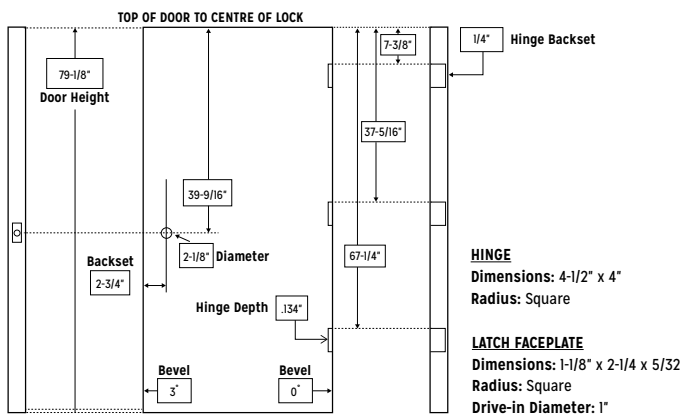

#### 7/0 Template

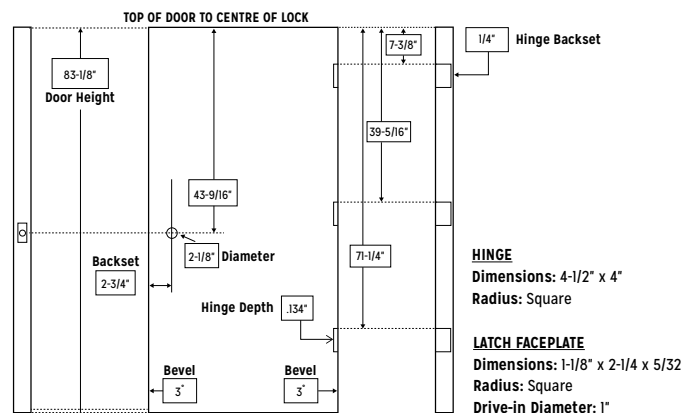



### HOLLOW METAL DOORS

Hollow Metal doors are available in 20, 18 or 16 gauge for commercial and industrial applications. Lockseam (LS) doors are made from Galvanneal steel. They are available in honeycomb core for interior use, insulated with polystyrene or polyurethane for exterior applications and sound transmission control. Fire rating to 3 hours. Also available with temperature rise core.

**Widths** 2/0 to 3/0, in 2-inch increments as standard, 3/6, 4/0

**Heights** 6/8 or 7/0, in 2-inch increments as standard.

Maximum sizes for double doors: 8/0 x 8/0.  
Custom, non-standard and oversize also available upon request.

### GLAZING OPTIONS

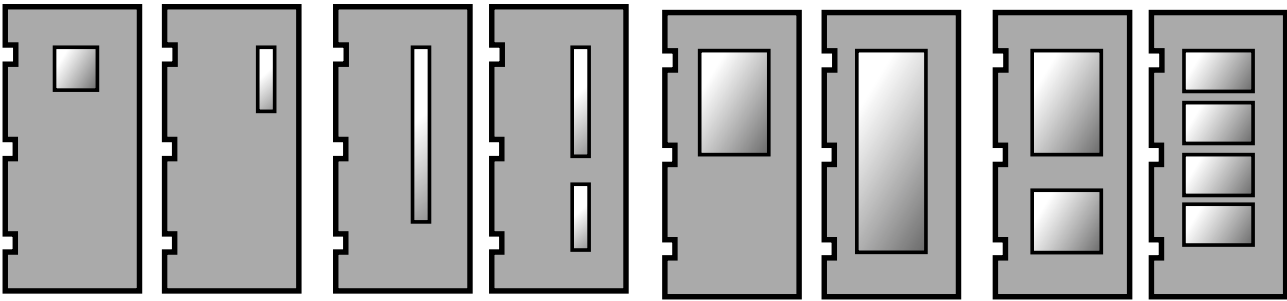

### DECORATOR OPTIONS

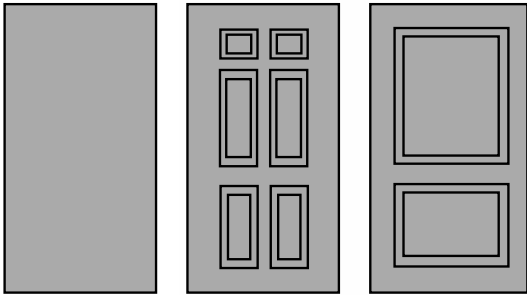

Flush

6 Panel

2 Panel

Up to 90  
minute fire  
rating

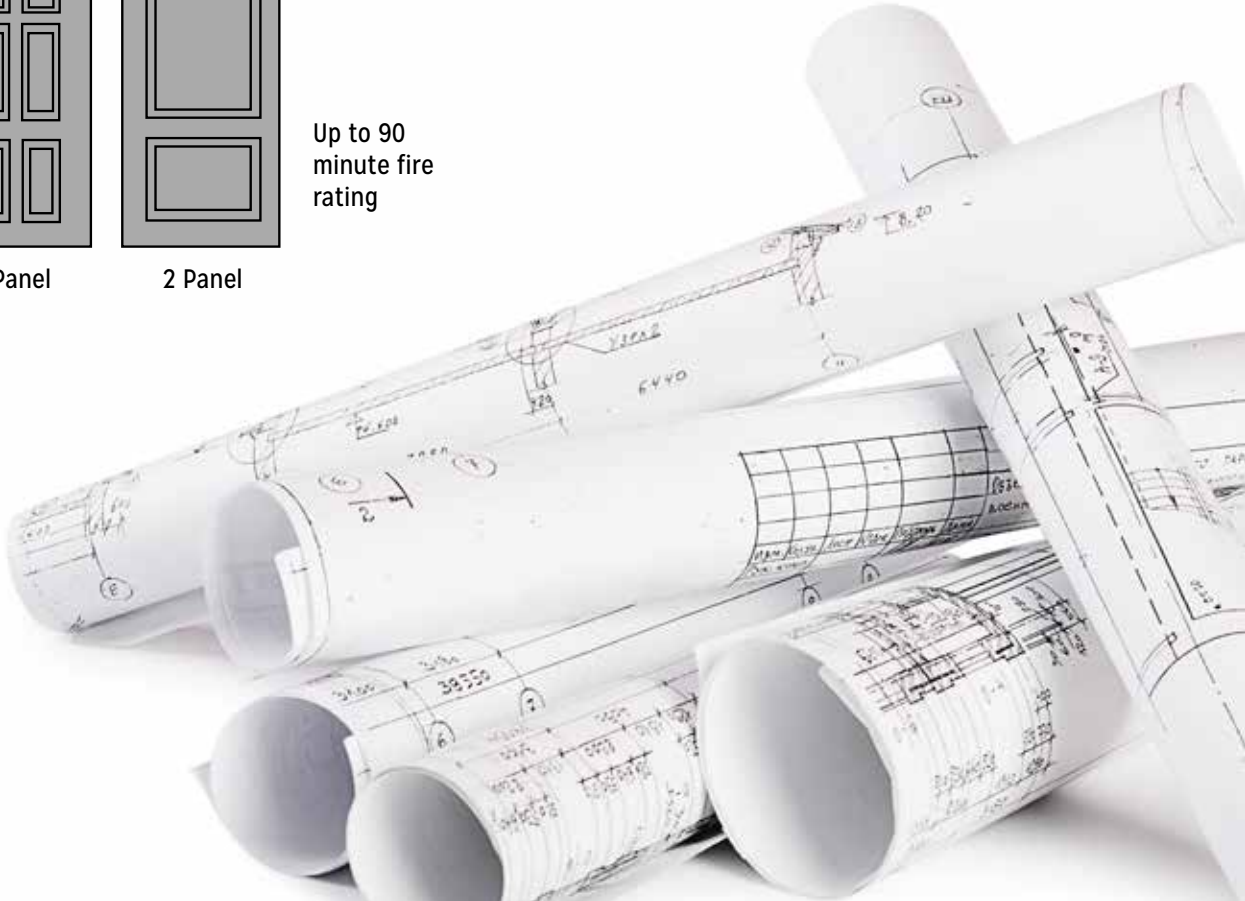

## DOOR OPTIONS



### SUITE ENTRY - MOULDED PANEL DOORS

 MASONITE.

The Masonite Collection of doors feature a smooth primed product ready for painting. Composite material provides a highly durable product at great value and a timeless look for years to come.

 FIRE-RATED WOOD



Carrara  
CARR



6 Panel  
Textured  
COL



Lincoln Park  
LINC



Riverside  
RIV

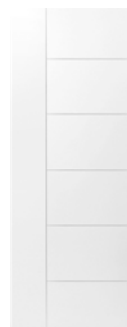

Berkley  
BER



Primed  
Hardboard  
HP



Livingston  
LIV



Logan  
LOGAN



Winslow  
WINS

## 20M FIRE RATED FRAMES

Complement your new door with a frame designed from primed finger-jointed pine or composite (smooth white or textured woodgrain). Available in 20 minute fire rating only.

For 45-90 minute fire ratings, see our selection of galvanized hollow metal frames.

Consider a prehung factory painted door system for ease of install.

### 20M FIRE RATED FINGER-JOINT PINE FRAME (PRIMED)

#### WITH KERF WEATHERSTRIPPING

Primed, kiln-dried finger-jointed pine jambs provide beauty and strength with a Warnock Hersey certified 20 minute fire rating. Suitable for interior or exterior use. Weatherstrip available in black or white.

**Sizes:** To partner with the door

**Jamb depth:** Up to 8-7/8"

#### WITHOUT KERF WEATHERSTRIPPING

Primed, kiln-dried finger-jointed pine jambs comply with a Warnock Hersey 20 minute fire rating. Optional smoke seal can be used with this jamb for extra sound and smoke protection.

**Sizes:** To partner with the door

**Jamb depth:** Up to 7-13/16"

### 20 MINUTE FIRE RATED COMPOSITE FRAME



Nan Ya's unique composite jamb offers built-in advantages unmatched in the door industry. Maintenance-free composite provides a tough exterior finish—resistant to dents, dings and scratches—and solid composite structure offers superior screw holding power, which means less work for you and a longer life for your entry unit.

Composite frames are available in either pre-pigmented smooth white or woodgrain textured finishes. Though finishing is not required for smooth white frames, they will accept an array of paint colours to match the design and finish of the door. Woodgrain textured frames have a realistic rich appearance, requiring paint or stain to achieve the warmth and beauty of natural wood. Factory finishing available.

**Sizes:** To partner with the door

**Standard jamb depth:** 4-9/16", 6-9/16", 8-9/16"



Frame with kerf weatherstripping



Frame without kerf weatherstripping



Composite frame with kerf weatherstripping, available in black or white

## STEP 3: HARDWARE - RETAIL PROGRAM

### HINGES

#### NRP BALL BEARING 4-1/2" HINGES

##### Specifications:

- 4-1/2" X 4" Ball Bearing Hinges / Set of 3
- Non removable pin (NRP) for outswing application
- Suitable for moderate to high traffic applications
- Satin Chrome finish
- Quality wood screws and template machine screws are included
- Available in case lot quantity
- Included in the Retail Jamb Kit



Non-removable pin ball bearing 4 1/2" hinges  
Q-C26D 41/2BBNRP SET

#### SELF CLOSING HINGE 4-1/2" X 4 SQ

(Sold Separately)

##### Specifications:

- 4-1/2" X 4" Self Closing Hinge / per each
- Suitable for moderate to high traffic applications
- Satin Chrome finish
- Quality wood screws and template machine screws are included
- Available in case lot quantity



Self Closing 4 1/2" hinges  
Q-C26D 41/2SCH



## DOOR CLOSERS

*Safety, security and uncompromising value. Available in case lot quantity.*

### FALCON SC90 SERIES DOOR CLOSERS

Designed for light to moderate duty and for interior/exterior applications, the Falcon Series closers ensure smooth and reliable operation while meeting ADA accessibility requirements. The SC90 series is preset for easy installation.

#### Specifications:

- Grade 3, single piece cast aluminum body
- Closer mounts hinge side, top jamb or parallel arm
- UL rated
- Non handed for left or right hand swinging doors
- Separate adjustable general speed or latch speed
- 10 year warranty
- **SC93 supports door weight of 90-145 lbs**
- **SC94 supports door weight of 125-190 lbs**

**FALCON®**



SC93 Door Closer  
Q-CLS SC93RW/PA-689



SC94 Door Closer  
Q-CLS SC94RW/PA-689

### DOREX 700 SERIES DOOR CLOSERS

The Dorex 700 Series fixed power door closer is recommended for use on a wide variety of residential and commercial applications with moderate traffic.

#### Specifications:

- Cast aluminum alloy body
- Non-gumming, non-freezing hydraulic fluid
- UL rated
- Non handed for left or right hand swinging doors
- Adjustable sweep or latch speed
- 5 year warranty
- **753 supports door weight of 90-145 lbs**
- **754 supports door weight of 125-190 lbs**

**DOREX®**



753 Door Closer  
Q-CLS 753 ALUM



754 Door Closer  
Q-CLS 754 ALUM

### SC61 SERIES DOOR CLOSER

When you need a dependable closer for a standard-duty application, the SC61 closer gets the job done. Designed for commercial exterior, interior and aluminum storefronts, it features the most common hole pattern in the door control industry making it ideal for a variety of retrofit needs.

#### Specifications:

- Certified Commercial Grade 1
- Single piece cast aluminum body
- Non handed for left or right hand swinging doors
- Separate adjustable general speed or latch speed
- 10 year warranty
- 689 Aluminum Finish

**FALCON®**



SC61 Door Closer  
Q-CLS SC61 RW/PA 689

## LEVERS

### DANE SERIES LEVERS

#### Specifications:

- Passage, Privacy, Keyed Entrance
- Grade 2 Ansi tested
- Locks are UL listed 3 hour A Label
- Locksets adjust to fit 1-3/8" to 1 3/4" door thickness
- All locksets are non-handed
- Heavy duty springs on trim for lever return and sag prevention
- Trim is thru-bolted
- All levers are solid and meet the necessary disability requirements



**FALCON**



Passage: Q-DANE W101S C26D  
Privacy: Q-DANE W301S C26D  
Entry: Q-DANE W511PD C26D

### DOREX SERIES LEVERS

#### Specifications:

- Passage, Privacy, Keyed Entrance
- Architectural quality for medium duty commercial applications
- Grade 2 ANSI tested
- Locks are UL listed 3 hour fire rating
- For 1-3/8" to 1 3/4" door thickness
- Non-handed/field reversible
- 1-2" stainless steel latch throw
- Removable thru-bolt mounting posts
- Concealed mounting screws



**DOREX**



Passage: Q-FH10-C26D  
Privacy: Q-FH42-C26D  
Entry: Q-FH53-C26D

## KNOBS

### HANA SERIES KNOBS

#### Specifications:

- Passage, Privacy, Keyed Entrance
- Grade 2 Ansi tested
- Locks are UL listed 3 hour A Label
- Locksets adjust to fit 1-3/8" to 1-3/4" door thickness
- All locksets are non-handed
- Heavy duty springs on trim for knob return and sag prevention
- Trim is thru-bolted



**FALCON**



Passage: Q-HANA W101S C26D  
Privacy: Q-HANA W301S C26D  
Entry: Q-HANA W511PD C26D

### DOREX SERIES KNOBS

#### Specifications:

- Passage, Privacy, Keyed Entrance
- Grade 2 Ansi tested
- Locks are UL listed 3 hour A Label
- Locksets adjust to fit 1-3/8" to 1-3/4" door thickness
- All locksets are non-handed
- Heavy duty springs on trim for knob return and sag prevention
- Trim is thru-bolted



**DOREX**



Passage: Q-TL10-C32D  
Privacy: Q-TL42-C32D  
Entry: Q-TL53-C32D

## DEADBOLTS

### 241P6F FALCON SINGLE CYLINDER DEADBOLT

#### Specifications:

- Integrated anti-pry shield behind cylinder assembly for added security and quicker installation
- Integrated trim design - fewer pieces out of box and improved installation time
- Tapered front resists wrenching
- Accepts small format interchangeable style cores (SFIC) and conventional cylinders
- Adjustable backset with lock-in-place design for greater versatility
- Heavy duty saw-resistant bolt with spinning hardened steel pin inside for additional protection
- ADA compliant thumbturn Grade 2



**FALCON**

Single Cylinder Deadbolt  
Q-D241P6F C26D

### TLA51 DOREX SINGLE CYLINDER DEADBOLT

#### Specifications:

- Architectural quality for medium duty commercial applications
- High quality stainless steel finish
- For 1-3/8" to 1-3/4" door thickness
- Backset to 2-3/4"
- Non-handed/field reversible
- Solid brass bolt with steel rod insert and full 1" throw
- ANSI/BHMA A156.5, Grade 2
- UL/cUL listed for 3 hour fire rating



**DOREX**

Single Cylinder Deadbolt  
Q-TLA51-C32D

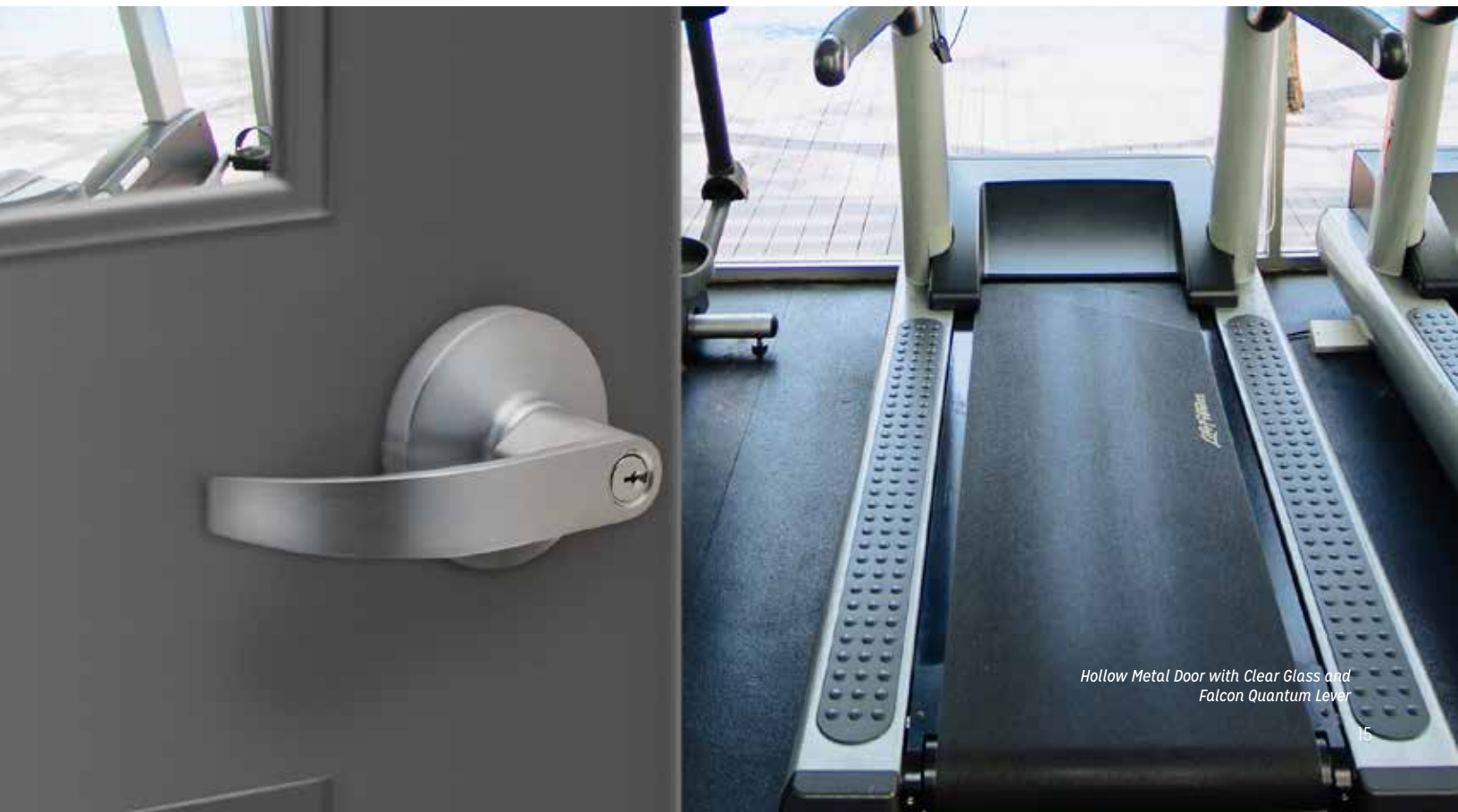

*Hollow Metal Door with Clear Glass and Falcon Quantum Lever*

## EXIT DEVICES & TRIM

### DOREX 8500 SERIES EXIT DEVICES & TRIM

#### Specifications:

- For medium duty commercial applications
- High quality aluminum powder coated finish
- Includes ASA strike filler and edge filler for retrofit applications
- Suitable for hollow metal and wood doors
- Field sizeable for doors 2/4 - 3/0
- Stainless steel springs and latchbolt with 3/4" throw
- Conforms to ANSI/BHMA A156.3, Grade 2
- UL and cUL listed for 1 1/2 hour fire rating
- 1 year limited warranty



Dorex 8500 Series Exit Device  
Q-8500FAL

### 8510 FH PASSAGE TRIM

#### Specifications:

- For medium duty commercial applications
- High quality satin chrome finish
- Passage function suitable for non-locking applications
- Non-handed/field sizeable
- 3" rosette diameter
- UL and cUL listed for 1 1/2 hour fire rating
- 1 year limited warranty



Dorex 8510 FH Passage Trim  
Q-8510FH-C26D

### 8570 FH CLASSROOM TRIM

#### Specifications:

- For medium duty commercial applications
- High quality satin chrome finish
- Classroom function suitable for doors that need to remain locked or unlocked for lengthy or specific periods
- Non-handed/field sizeable
- 3" rosette diameter
- Schlage C 6 pin keyable cylinder
- UL and cUL listed for 1 1/2 hour fire rating
- 1 year limited warranty



Dorex 8570 FH Classroom Trim  
Q-8570FH-C26D





## CHECK CHAINS

### 33" HEAVY DUTY CHECK CHAIN

Only required for exterior applications where wind will be a factor. It is added to support the closer and eliminate stress on the hinges

**Specifications:**

- 33" chain has the length to allow full 90 degree opening of the door
- Vinyl covering will not crack like plastic
- Cast aluminum mounting brackets



Q-CHECK CHAIN HD

### 25.5" HEAVY DUTY CHECK CHAIN

**Specifications:**

- 25.5" vinyl wrapped steel chain with two compression coiled springs
- Mounting screws included
- Zinc die-cast mounting brackets



Q-CHECK CHAIN 3560

## DOOR STOPS

### SM122 WALL MOUNT DOOR STOP

**Specifications:**

- 2-1/2" concave wall stop, 1" projection
- Suitable for moderate to high traffic applications
- Satin Chrome finish
- Mounting hardware included



S122 Wall Mount Door Stop  
Q-SM122-C26D

### T218 FLOOR MOUNT DOOR STOP

**Specifications:**

- 1/2" height base adjustable, high style
- Suitable for moderate to high traffic applications
- Satin Chrome finish
- Mounting hardware included



T218 Floor Mount Door Stop  
Q-T218C26D



## DOOR OPERATORS

*Durable & quiet automatic swing door operators transform virtually any interior door from manual to modern, touchpoint to touchless.*



### DITEC HA7 SLIM LOW ENERGY OPERATOR

### ENTRE//MATIC



● **EASY INSTALL**

Install is a quick and easy with no electrician needed. 120V outlet compatible

● **CUSTOM FUNCTIONS**

Make the HA7 work for you by customizing preferences for a more personalized experience.

● **DOOR CONTROL**

Features like partial open, hold open, push & go, power assist, and stop on stall are all at your fingertips.

● **MULTI-PLATFORM ACCESSIBILITY**

Available through both the Apple and Google Play stores means more control for more people.



DITEC HA7 SLIM LOW ENERGY OPERATOR	
HA7-COMBO-39CLR	Entrematic HA7 Single Push/Pull Operator
HA7-COMBO-39CLR-KIT	Entrematic HA7 Single Push/Pull Operator Kit with Plates, Transmitters and Receivers





**DITEC HA8-SP STANDARD PROFILE LOW ENERGY OPERATOR**

HA8-SP is the standard profile low-energy operator that works in high-traffic interior applications. The standard profile can be installed in hospitals, retail stores, schools, airports, convention centers, industrial buildings, and offices.



Ditec HA8 in clear with push arm  
HA8LP-PUSH-LH-39CLR



Ditec HA8 in bronze with pull arm  
HA8LP-PULL-RH-39BRZ



**DITEC HA9 FULL FEATURED LOW ENERGY OPERATOR**

HA9 is a low-energy operator loaded with features while offering the same quiet, dependable operation you've come to expect in a low-profile header size. The HA9 is perfect for high-traffic locations including schools, hospitals, retail stores, airports, convention centers, industrial buildings, and offices.



Ditec HA9 in bronze with push arm  
HA9-PUSH-39BRZ



Ditec HA9 in clear with pull arm  
HA9-PULL-39CLR

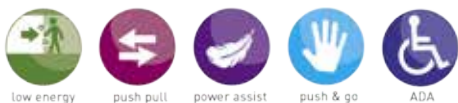

DITEC HA9 FULL FEATURED LOW ENERGY OPERATOR	
HA9-PULL-39BLK	HA9 PULL - BLACK FINISH
HA9-PULL-39BRZ	HA9 PULL - BRONZE FINISH
HA9-PULL-39CLR	HA9 PULL - CLEAR FINISH
HA9-PUSH-39BLK	HA9 PUSH - BLACK FINISH
HA9-PUSH-39BRZ	HA9 PUSH - BRONZE FINISH
HA9-PUSH-39CLR	HA9 PUSH - CLEAR FINISH

# STEP 4: WEATHERSEALS - RETAIL PROGRAM

## THRESHOLD AND WEATHERSTRIP KIT

*Designed for exterior use single entry frames requiring high performance weatherstripping, sill and sweep.*

### KIT INCLUDES:

#### Sill

- Extruded aluminum
- 5" wide x 1/2" rise x 36" long
- Punched and countersunk for #10 Robertson flat head wood screw
- Wheelchair accessible
- UL Fire Labelled

#### Weatherstrip

- 1 set 1-36" & 2-84"
- Extruded aluminum c/w cold temperature vinyl insert.
- Actual size: 1-1/8" (28.7mm) wide.

#### Sweep

- 1 pc. 36" sweep with neoprene insert
- Extruded aluminum clear anodized
- Actual size: 1-3/8" (28.7mm) high x 36" length.

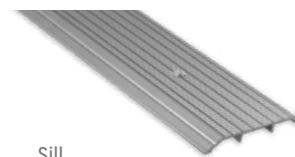

Sill



Weatherstrip



Sweep

Complete Kit: Q-QDS5





## WEST FOUR ALUMINUM ENTRANCE PROGRAM

### ALUMINUM ENTRANCE

#### Door Features:

- Door comes pre-glazed with sealed unit, clear tempered glass
- Door is pre-hung in an assembled thermally broken frame with standard hardware
- Options for interior and exterior use
- Durable and virtually maintenance free
- Maximum security deadbolt lock
- Architectural curved push/pulls
- Mechanically fastened shear blocks and welded corner construction
- Adaptable to virtually all hardware
- Glass stops with bulb gaskets
- 1/4" or 3/4" glazing options available
- Adaptable to meet local building codes
- Ready to install
- Limited lifetime warranty



#### Standard Hardware:

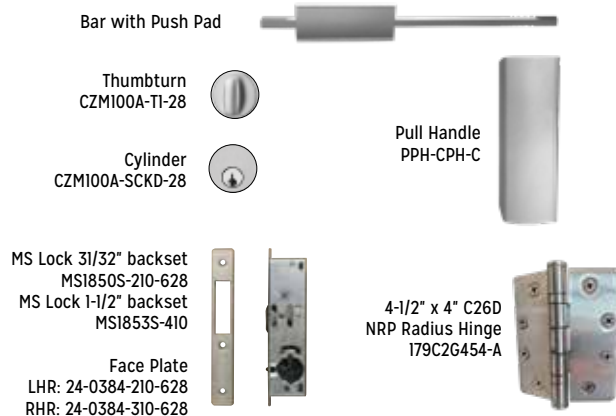

#### Specifications:

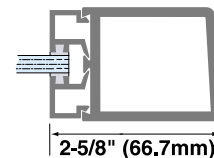

Series 212 - Narrow Stile



FLOOR MOUNTED



FLOOR TO CEILING



CEILING MOUNTED



HEADRAIL BRACED



**hadrian®**

**TOILET PARTITIONS AND LOCKERS**

Hadrian is a worldwide supplier of quality toilet partition and locker products. Hadrian was the first manufacturer to powder coat toilet partitions and has continued to embrace new technologies and materials in order to offer architects, designers and end-users more flexibility in design.

Hadrian's wide range of toilet partition products includes powder coated metal, stainless steel, embossed stainless steel, and solid plastic. Lockers are available in Emperor (corridor), Gladiator (athletic), and replacement front styles.



**ACCESS DOORS & HATCHES**

Our roof hatch product offering includes a complete line of roof access and safety products.



**MAILBOXES**

Vertical or horizontal, recessed wall mounted mailboxes that meet Canada Post standards.



**WASHROOM ACCESSORIES**



Bobrick is recognized as an industry leader in well-designed, value-oriented washroom accessories



Architects and engineers turn to Bradley for the industry's most innovative products specified for commercial washrooms and industrial safety applications



Frost has earned a reputation for manufacturing quality washroom products that offer both durability and value.



From hand dryers and hair dryers, to vacuums, purifying fans and lighting, Dyson technology is engineered with your employees and guests in mind.



ASI is the world's leading manufacturer of commercial partitions, washroom accessories, lockers, and visual display products. ASI designs, engineers, and manufactures fully-integrated solutions so all products work together seamlessly.





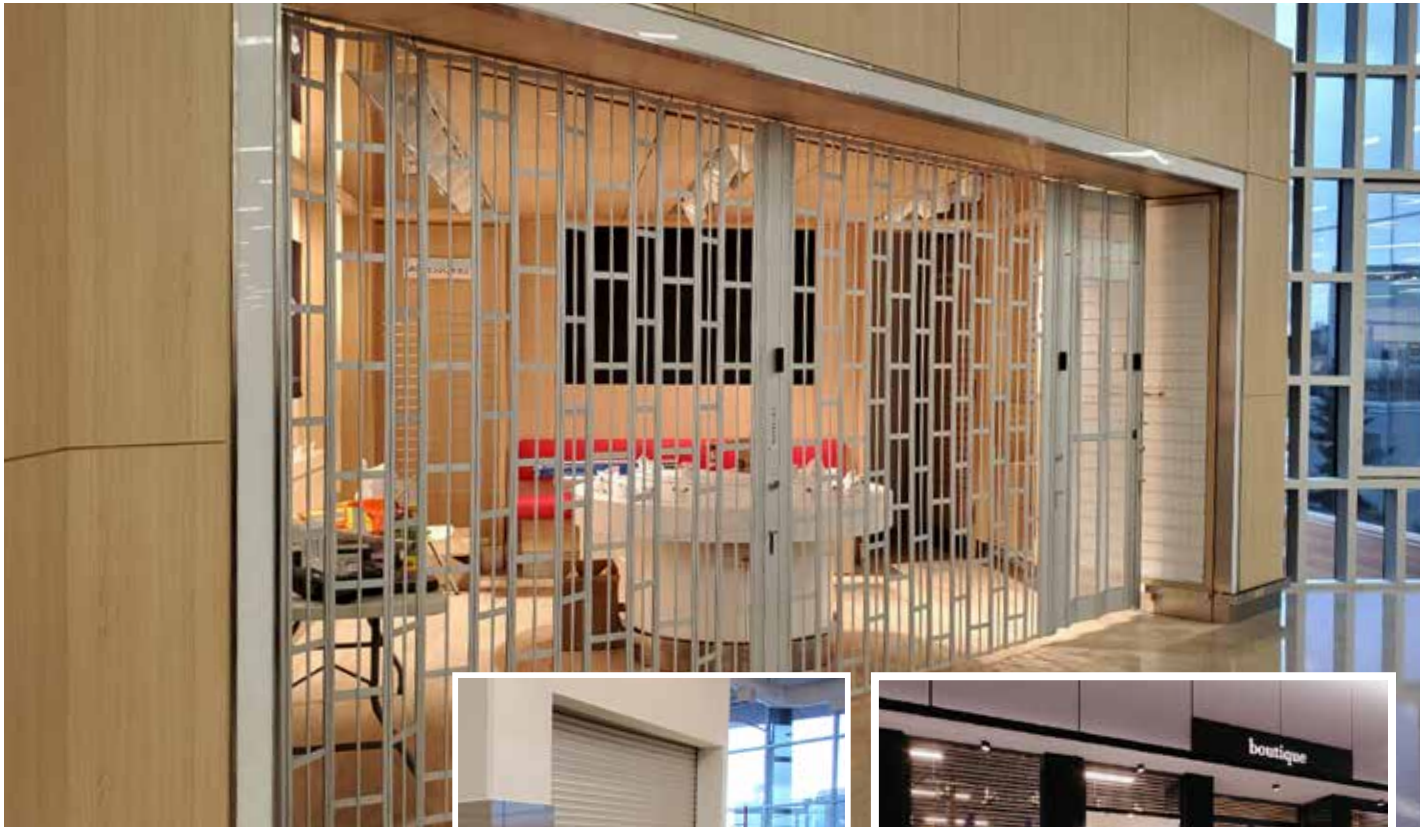

### ROLLING SHUTTERS & SLIDING GRILLES

Rolling shutters and sliding grilles close off an entrance and provide protection from theft and vandalism.



### GARBAGE & LAUNDRY CHUTES

Fire-rated standard chute doors for garbage, linen or recycling systems.





**BEFORE YOU START**

Where is this door going? \_\_\_\_\_

Traffic Usage:  Low  Medium  High

Is it a Fire Rated Opening?  Yes  No



**COMMERCIAL  
Ordering Checklist**

**STEP 1: CHOOSE YOUR FRAME**

**3 Pc, Knockdown Frames:**

**18 Gauge**

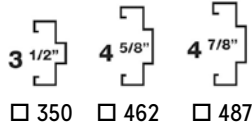

**16 Gauge**

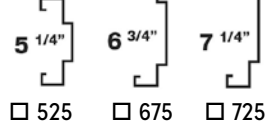

**Welded Frames - 16 Gauge: (Require Anchors)**

**Throat Size**

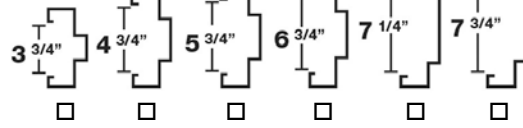

**Expandable  
Frames Field  
Adjustable  
for Walls:**

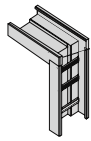

**XF - Square  
Corner**  
4-1/2" to 7-7/8"

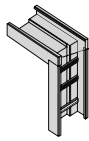

**XF Large -  
Square Corner**  
7-5/8" to 12-1/2"

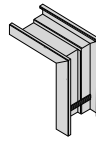

**EF2**  
5-3/8" - 8-11/16"

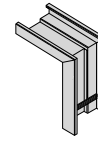

**EF3**  
8-11/16" - 12"

**Wall Anchors  
for Welded  
Frames:**

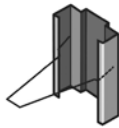

**Masonry  
Wire Anchor  
(WA)**



**Steel  
Building  
Anchors  
(SBA)**



**Existing Wood  
Wall Anchor (EWA)**  
  
 **Existing Masonry  
Wall Anchor (EMA)**

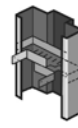

**Adjustable  
Stud Anchor -  
Wood or Steel  
Studs  
(Anchor A)**

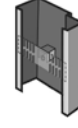

**Masonry  
Tube Shim  
Anchor**

**STEP 2: CHOOSE YOUR DOOR**

**Choose door width:**

2'  2'4"  2'6"  2'8"  2'10"  3'  3'6"  4'

**Choose door height:**

6'8"  7'

**Choose door gauge:**

20  18  16

**Insulated**  Yes  No

**Double Drilled**  Yes  No

**Standard  
Door  
Types:**

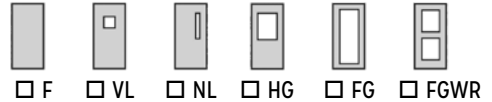

**Handing  
of Door:**

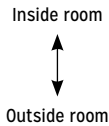

**Right Hand (RH)**

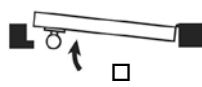

**Left Hand (LH)**

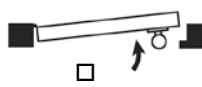

**Right Hand Reverse (RHR)**

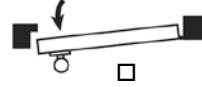

**Left Hand Reverse (LHR)**

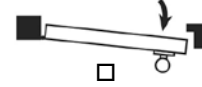

**Frame / Door /  
Hardware  
Configuration:**



Single Drill,  
Hinges

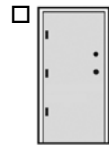

Double Drill,  
Hinges



Single Drill,  
Closer Prep,  
Hinges

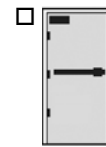

Exit Device,  
Closer, Hinges

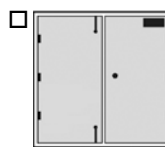

Single Drill, Lock,  
Closer, Flush Bolt,  
Hinges



Exit Device, Closer,  
Removable Mullion,  
Hinges

**STEP 3: CHOOSE YOUR HARDWARE**

- |  |                                      |                                      |                                     |   |
|--|--------------------------------------|--------------------------------------|-------------------------------------|---|
| <input type="checkbox"/> Hinges        | <input type="checkbox"/> Privacy Set | <input type="checkbox"/> Exit Device | <input type="checkbox"/> Door Pull  | <input type="checkbox"/> Weatherstrip / Sweep / Threshold |
| <input type="checkbox"/> Keyed Lockset | <input type="checkbox"/> Deadbolt    | <input type="checkbox"/> Flushbolt   | <input type="checkbox"/> Push Plate | <input type="checkbox"/> Door Viewer                      |
| <input type="checkbox"/> Passage Set   | <input type="checkbox"/> Closer      | <input type="checkbox"/> Check Chain | <input type="checkbox"/> Kick Plate | <input type="checkbox"/> Door Stop                        |

Comments \_\_\_\_\_

Customer Signature: \_\_\_\_\_ Date: \_\_\_\_\_

Store Name or #: \_\_\_\_\_ Tag: \_\_\_\_\_ PO #: \_\_\_\_\_

Contact at Store: \_\_\_\_\_



XL Retail Display

## Madero's Commercial Merchandiser



Large Retail Display

### CONTACT US AT

Email: [commercial@madero.ca](mailto:commercial@madero.ca)

All commercial quote requests can be sent to this email address.  
Please include as much information as possible, full plans and specs if available.

Phone: 1-800-667-6977  
(Press 2 for Commercial Inquiries)

Designed & printed by



MAD040-23