

YOUR DOOR STYLIZER™

INSTALLATION INSTRUCTIONS

Replace Glass
In Your Door

OR

Add Glass
In Your Door

Stylize Your Door. It's Simple.

A beautifully designed entry sets the stage for the rest of your home.

With the **Your Door Stylizer**, you'll find doorglass styles that suit your home perfectly.

It's a wise investment that improves the look and value of your home and adds beauty to everyday living.

ODL® Doorglass is simple to install. No mess. No caulking. No delays in ordering.

JUST MEASURE, SELECT A STYLE, REMOVE THE OLD GLASS AND INSTALL THE NEW.

The toughest task you'll face is choosing a new doorglass style.

1 MEASURE

FITS STANDARD SIZE DOORS



2 REMOVE

THE EXISTING DOORGLASS



3 REPLACE

WITH NEW DOORGLASS

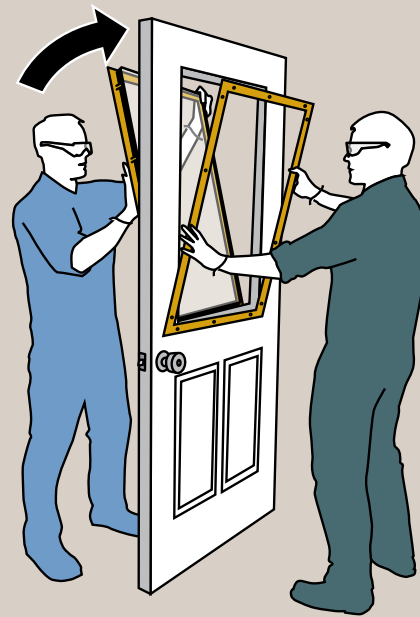

INSTALLATION INSTRUCTIONS

STATEMENT OF INTENDED USE

ODL® Doorglass panels are for use in 1¾" thick residential steel and fiberglass doors.

They are not designed for use in wood doors, doors that do not have rigid steel frames, or as windows in a wall.

ANY MISUSE OR INSTALLATION OTHER THAN STATED WILL VOID THE WARRANTY.

**SAFETY
FIRST!**

CAUTION

When working with glass and frames, care should be taken. ODL Doorglass is made of tempered safety glass but **should be carefully supported at all times.** The smaller sized glass can be installed vertically, but we recommend that the 22"x 64" glass be installed with the door off the hinges and lying down.

Because the frames and glass are heavy and of an awkward size, **two installers may be required** to remove the old glass from the opening and lift the ODL Doorglass.

TOOLS

FIND A HELPER (or Glass Handling Suction Cups)

- Safety Gloves
- Safety Glasses
- Dry Wall Screw (size optional)
- Power Screw Driver with Phillips Head Bit
- Level
- Putty Knife
- Window Cleaner

MORE TOOLS

IF YOU NEED TO CUT AN OPENING...

Additional tools will be needed.

- 2 Saw-horses
- Drill with 3/8" or 1/2" bit
- Jigsaw with a short-stroke blade
- Painter's Tape

INSTALLATION INSTRUCTIONS

1

MEASURE & INSPECT

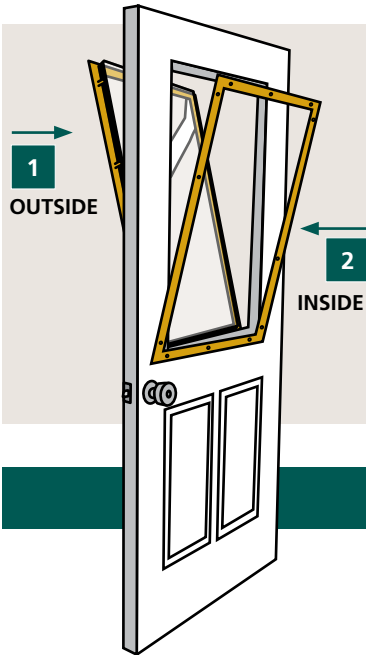

DOORGLASS CONSTRUCTION

ODL Doorglass is made up of **two different sections**:

- 1. AN OUTSIDE** frame section containing the glass, and
- 2. THE INSIDE** frame section with holes for the attachment screws.

The attachment screws are placed into the doorglass from the inside of the home for added security.

MEASURE THE EXISTING OPENING

ODL Doorglass is intended to be used as a replacement product.

Existing doorglass must be removed prior to installing this product.

Removal may make the existing doorglass or sidelight unusable.

Refer to the following chart before removing the existing doorglass.

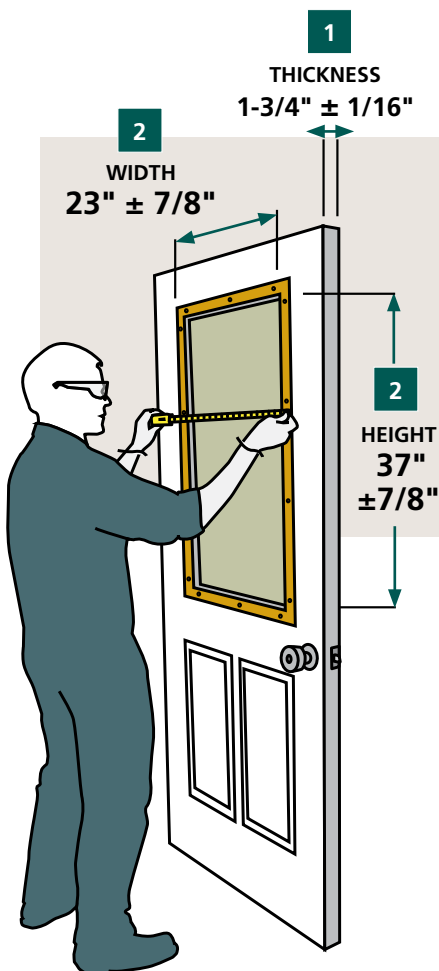

MEASURE THE EXISTING OPENING IN TWO PLACES

If the measurement is not within this range, consult with an ODL Customer Service Representative for help.

- 1. MEASURE THE THICKNESS** of the existing door. ODL Doorglass is designed to **FIT OPENINGS THAT ARE 1-3/4" ± 1/16" THICK.**
- 2. MEASURE THE HEIGHT AND WIDTH** of the existing doorglass. If the measurements correspond to the chart, ODL Doorglass will fit your door.

GLASS SIZE	1/2 DOORGLASS	FULL DOORGLASS
ODL DESIGNATED	22" x 36"	22" x 64"
OUTSIDE OF FRAME TO OUTSIDE OF FRAME	23-7/8" x 37-7/8"	23-7/8" x 65-7/8"

INSTALLATION INSTRUCTIONS

2

REMOVE FRAME & GLASS

USE DRYWALL SCREW TO REMOVE
SCREW HOLE PLUGS

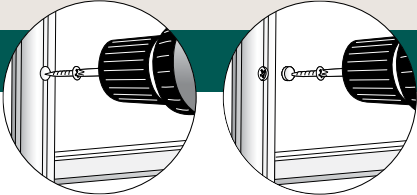

LOCATE SCREWS AND LOOSEN THEM

Old paint, putty, or caulk may need to be removed from the screws first.

HAVE A HELPER
SUPPORT THE GLASS

REMOVE SCREWS AND INNER FRAME

Once the screws are loosened, **have a helper stand on the outside of the door and hold the frame.** REMOVE ALL ATTACHMENT SCREWS AND REMOVE THE INNER FRAME.



REMOVE OUTER FRAME

INSERT THE PUTTY KNIFE

between the outer frame and the door to break the old caulk seal.

TIP: Spray window cleaner around outer frame's edge to help release caulk.

CAREFULLY PRY FRAME LOOSE

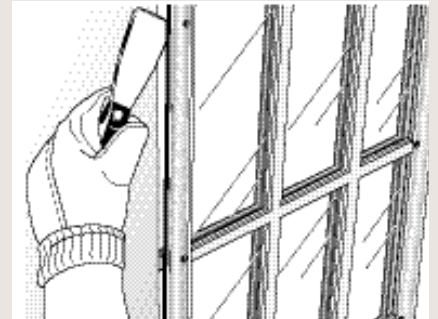

REMOVE EXISTING DOORGLASS

While wearing safety glasses and gloves, **GENTLY REMOVE THE EXISTING DOORGLASS.**

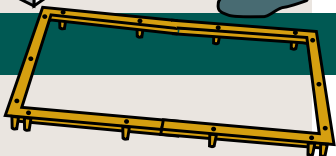

CLEAN & PREPARE DOOR SURFACE

After the doorglass has been safely removed, **CAREFULLY SCRAPE** any old or excess caulk and dirt from the inside and outside openings.

INSTALLATION INSTRUCTIONS

2A

CUT AN OPENING

CUTTING A STEEL OR FIBERGLASS DOOR

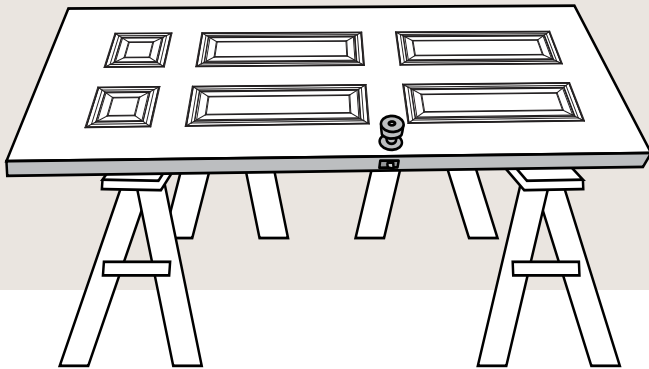

IF DOORGLASS IS NOT CURRENTLY PRESENT OR IF A NEW OR LARGER SIZE DOORGLASS IS BEING INSTALLED, FOLLOW THESE STEPS:

1. REMOVE DOOR FROM HINGES
2. LAY DOOR ACROSS SAWHORSES

MEASURE, MARK, AND CUT

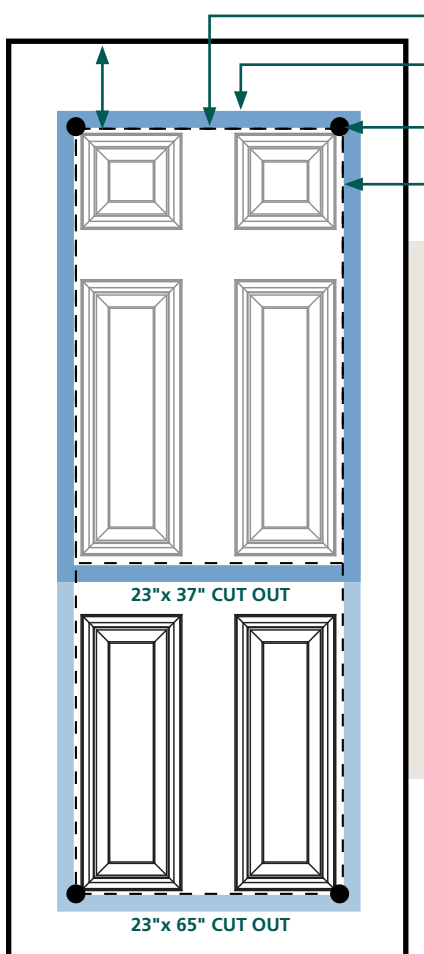

- 3 MEASURE AND MARK
- 4 APPLY PAINTER'S TAPE
- 5 DRILL STARTER HOLES
- 6 CUT ALONG GUIDELINE

3. Refer to "EDGE OF OPENING TO EDGE TO OPENING" chart below for correct size, **MEASURE AND MARK CUTTING AREA** of front side of door.
4. **APPLY PAINTER'S TAPE** around cutting area to prevent damage while cutting.
5. **DRILL 3/8" OR 1/2" STARTER HOLE** in all 4 corners of the measurement.
6. Using starter hole, **INSERT JIG SAW** with a short-stroke blade into the inner core of the door and **CUT ALONG MARKED GUIDELINES**, corner to corner.
7. **FLIP DOOR OVER AND REPEAT STEPS 3 TO 6** for back side of door.
8. **REMOVE TAPE AND DEBRIS**

GLASS SIZE	1/2 DOORGLASS	FULL DOORGLASS
EDGE OF OPENING TO EDGE OF OPENING	23 ± 1/8" x 37 ± 1/8"	23 ± 1/8" x 65 ± 1/8"

INSTALLATION INSTRUCTIONS

3

INSTALLING NEW DOORGLASS

KEY NOTE:

OUTER FRAME CONTAINS NO SCREW HOLES and should be installed on exterior of door.

INNER FRAME WILL HAVE SCREW HOLES and should be installed on the interior of the door.

CONNECT THE DOORGLASS FRAMES



- 1. LIFT THE OUTSIDE SECTION** of the replacement doorglass frame **INTO POSITION** from the outside
- 2. LIFT THE INSIDE FRAME INTO POSITION** matching up the screw bosses. (males and female)

INSERT SCREWS

- 3. INSERT SCREWS**, but do not tighten fully
- When both halves of the frame are together, **place a level on the doorglass frame**. Adjust the frame until the bottom of the doorglass is level.
- 5. TIGHTEN THE SCREWS FIRMLY** so that the frame fits snugly against the door and the seal is compressed.
OVER-TIGHTENING OF SCREWS PREVENTS NATURAL EXPANSION AND SHRINKING DUE TO TEMPERATURE CHANGES.
- 6. INSERT AND TAP IN SCREW PLUGS** over screw holes.
7. Clean new glass using a window cleaner
8. Paint or finish frame if desired.

CAUTION!

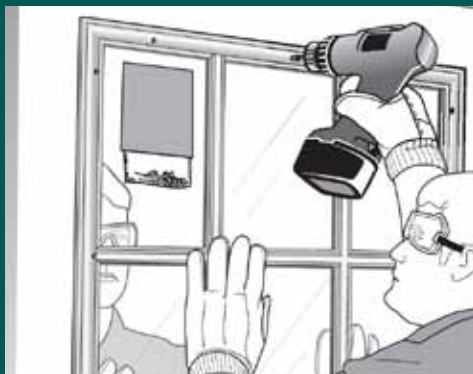

CAUTION

DO NOT OVER-TIGHTEN THE SCREWS INTO THE DOOR FRAME.

4

FINISHING THE FRAME

CONSIDER PAINTING OR STAINING THE DOORGLASS FRAME TO COORDINATE WITH YOUR DOOR FINISH.

The frames of ODL doorglass products can be left unpainted, painted, or stained to match your home's decor, depending on the frame material. **SURFACE PREPARATION AND FINISHING INSTRUCTIONS VARY DEPENDING ON FRAME TYPE.** Product labels will list specific frame materials. Contact ODL if you need assistance identifying your frame material.

ODL Doorglass Warranty Information

ODL Doorglass is covered by a limited warranty. The warranty does not apply to damage from shipping, handling, installation, storage, environmental conditions, or unusual service conditions or usage.

For warranty information contact:

ODL Customer Service, 215 East Roosevelt Ave., Zeeland, MI 49464.

www.odl.com

1.800.253.3900