

EXTERIOR DOOR SYSTEMS | INTERIOR DOOR SYSTEMS | **COMMERCIAL** | HARDWARE



COMMERCIAL  
2020



**madero.ca**

Madero has been a distributor to building supply dealers in Western Canada since 1987. We have a complete commercial offering to support the retail packaged products available.

Contact your sales associate to determine the best products for your commercial project.





XL Retail Display



Large Retail Display

## Madero's Commercial Retail Stocked Display

Madero offers a full line of architectural hardware, commercial hollow metal doors and frames, building accessories and specialty products. With access to a wide variety of products from industry-leading manufacturers, Madero is able to source the necessary materials for your customer's building project.

## STEP 1. CHOOSE YOUR FRAME

# EXPANDABLE REVERSIBLE JAMB KIT

Daybar Expandable Series Frames are an ideal solution for commercial building applications and retrofit work on existing buildings, specifically when existing wall types are unknown or vary throughout the project.

## EF-K REVERSIBLE SQUARE CORNER, 18 GA.

**Height:** 6/8 to accept 79 1/8" door slab

**Width of Door Slab:**

Nominal: 2/8 or 3/0

Actual: 35-3/4 or 31-3/4

**Expandable** from 4-1/2" to 7-7/8"

**Reversible** to accommodate inswing, outswing, left or right hand

**Kit Includes:**

### Jamb Set

- 18 ga. Galvanneal steel
- 3 pieces: header, hinge jamb and single strike jamb for assembly in wall openings during construction or renovation

### Hinges (3 included)

- 4-1/2"x4" ball bearing commercial grade hinges
- Square corners
- Non-removable pin
- Satin Chrome 26D finish

### Expandable Slide Bracket

- 16 ga. Galvanneal steel, spot welded to frame
- 3 sliders on frame jambs and two sliders on frame heads allow for smooth operation

### Reinforcements

- Welded to the frame for 3 hinges and strike placement
- Strike jamb leg is prepped for 4-7/8" ANSI strike
- Closer reinforcement is 12 ga. and welded to the header

The frame has a interlocking header that attaches to the jamb legs and is fixed into place with drywall screws when the frame is installed against both sides of the wall.

The frame has two frame face dimple locations on the jamb legs and one in the centre of the header, as well as two holes to attach the header to the frame.

There are no anchors required for the EFK frame. The bottom dimple holes on each side screw to the drywall frame to ensure its stability.

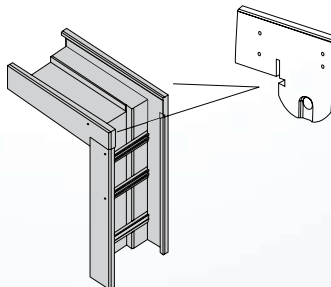

Fire rated from 45 up to 90 minutes

## PRIMER NOT REQUIRED

Galvanneal steel is matte grey and ready for the finish paint



## OPTIONAL JAMB SPECIFICATIONS

- Deadbolt prep - contact sales associate for details
- 7/0 height
- Drywall frames and welded frames

## ROUGH OPENING

**Nominal Width:**  
Door width plus 1-3/4"

**Nominal Height:**  
Door height plus 1"

## STEP 2. CHOOSE YOUR DOOR

# HOLLOW METAL DOORS

The Madero retail door program includes 20 gauge hollow metal doors for commercial buildings, outbuildings and fire rated residential applications. LS series Galvanneal steel doors are available with two core options; honeycomb core for interior use, or insulated with polystyrene or polyurethane for exterior applications and sound transmission control.

## 20 GA. LOCKSEAM STEEL DOOR 1-3/4"

Lock seam and beveled edges mechanically interlocking seams on door edges only.

**Closer Reinforcement:** 14 ga. closer reinforcement, fitted to 16 ga. inverted top channel

**Hinge Reinforcement:** 7 ga. hinge reinforcement; to accept (3) 4-1/2" hinges

**Lock Preparation:** ANSI 161 lock reinforcement; 14 ga. prepared for 2-3/4" backset

**Beveled** to 1/8" or 2 degree bevel

**Size Specifications:** 6/8 reversible doors will accommodate inswing, outswing, left hand or right hand.

### Nominal size

- 2/8" x 6/8"
- 3/0" x 6/8"

### Actual size

- 31-3/4" x 79-1/8"
- 35-3/4" x 79-1/8"

Special order available in 2/0 to 3/6 widths and 7/0 (83-1/8) in height. 7/0 requires handing when order is placed.

### Core Options:

#### Honeycomb core (HM)

- **Usages:** Interior, fire rated
- **Specs:** R Value 2.5, STC 32

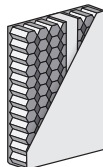

#### Polystyrene (HMIS)

- **Usages:** Exterior, sound
- **Specs:** R Value 6.6, STC 34

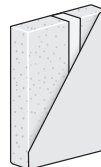

### Hinge Placement:

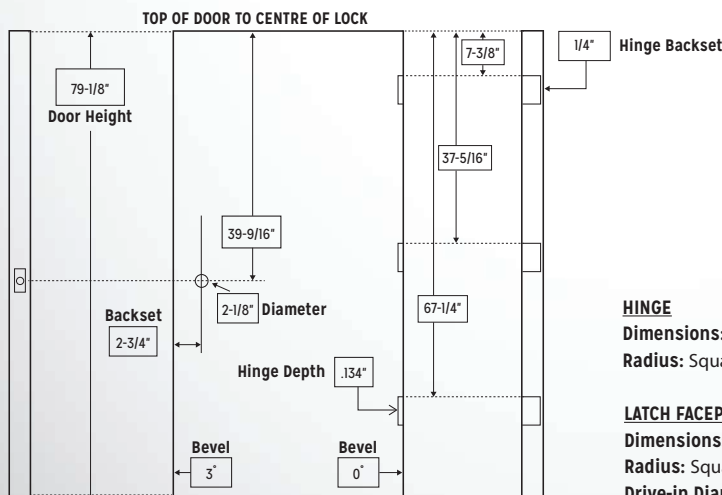

#### HINGE

**Dimensions:** 4-1/2" x 4"  
**Radius:** Square

#### LATCH FACEPLATE

**Dimensions:** 1-1/8" x 2-1/4" x 5/32"  
**Radius:** Square  
**Drive-in Diameter:** 1"

## DAYBAR



Intertek

Honeycomb filled doors are fire rated to 90 minutes with a label attached.

### PRIMER NOT REQUIRED

Galvanneal steel is matte grey and ready for the finish paint

WHI listed door glazing kits available. Contact your sales associate.

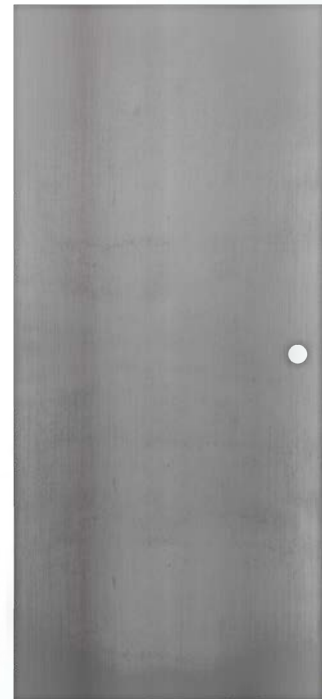

### WHAT IS DAYBAR QUALITY?

Daybar quality is built on 50 years of manufacturing experience, broad fire and physical endurance certification capabilities and the best warranty program available in the industry.

## STEP 3. CHOOSE YOUR HARDWARE

# KNOBS, LEVERS & DEADBOLTS

## 241P6F SINGLE CYLINDER DEADBOLT

### Specifications:

- Integrated anti-pry shield behind cylinder assembly for added security and quicker installation
- Integrated trim design - fewer pieces out of box and improved installation time
- Tapered front resists wrenching
- Accepts small format interchangeable style cores (SFIC) and conventional cylinders
- Adjustable backset with lock-in-place design for greater versatility
- Heavy duty saw-resistant bolt with spinning hardened steel pin inside for additional protection
- ADA compliant thumbturn Grade 2

## DANE SERIES LEVERS

### Specifications:

- Passage, Privacy, Keyed Entrance
- Grade 2 Ansi tested
- Locks are UL listed 3 hour A Label
- Locksets adjust to fit 1-3/8" to 1 3/4" door thickness
- All locksets are non-handed
- Heavy duty springs on trim for lever return and sag prevention
- Trim is thru-bolted
- All levers are solid and meet the necessary disability requirements

## HANA SERIES KNOBS

### Specifications:

- Passage, Privacy, Keyed Entrance
- Grade 2 Ansi tested
- Locks are UL listed 3 hour A Label
- Locksets adjust to fit 1-3/8" to 1-3/4" door thickness
- All locksets are non-handed
- Heavy duty springs on trim for knob return and sag prevention
- Trim is thru-bolted

**FALCON**® A division of Allegion Hardware.



Single Cylinder Deadbolt



Dane Lever



Hana Knob



## STEP 3. CHOOSE YOUR HARDWARE

# DOOR CLOSERS

*Safety, security and uncompromising value.*

## SC90 SERIES DOOR CLOSER

Designed for light to moderate duty and for interior/exterior applications, the Falcon Series closers ensure smooth and reliable operation while meeting ADA accessibility requirements. The SC90 series is preset for easy installation.

### Specifications:

- Grade 3, single piece cast aluminum body
- Closer mounts hinge side, top jamb or parallel arm
- UL rated
- Non handed for left or right hand swinging doors
- Separate adjustable general speed or latch speed
- 10 year warranty
- SC93 supports door weight of 90-145 lbs
- SC94 supports door weight of 125-190 lbs

**FALCON**® A division of Allegion Hardware.



SC93 Door Closer



SC94 Door Closer

# HEAVY DUTY CHECK CHAIN

Only required for exterior applications where wind will be a factor. It is added to support the closer and eliminate stress on the hinges

### Specifications:

- 33" chain has the length to allow full 90 degree opening of the door
- Vinyl covering will not crack like plastic
- Cast aluminum mounting brackets



Checkchain with vinyl cover and cast aluminum mount

# HINGES

## NRP BALL BEARING 4-1/2" HINGES (OUTSWING) BALL BEARING 4-1/2" HINGES (INSWING)

*Note: Hinges are included in the expandable jamb frame kit.*

### Specifications:

- 4-1/2" X 4" Ball Bearing Hinges / Set of 3
- Non removable pin (NRP) for outswing application
- Suitable for moderate to high traffic applications
- Satin Chrome finish
- Quality wood screws and undercut machine screws are included

## SPRING HINGE 4-1/2" X 4 SQ

### Specifications:

- 4-1/2" X 4" Spring loaded self closing hinge
- Suitable for moderate to high traffic applications
- Satin Chrome finish
- Quality wood screws and machine screws are included



Non-removable pin ball bearing 4 1/2" hinges



Spring loaded 4 1/2" hinges

## STEP 3. CHOOSE YOUR HARDWARE

# DOOR STOPS

## S122 WALL MOUNT DOOR STOP

### Specifications:

- 2-1/2" concave wall stop, 1" projection
- Suitable for moderate to high traffic applications
- Satin Chrome finish
- Mounting hardware included

## T218 FLOOR MOUNT DOOR STOP

### Specifications:

- 1/2" height base adjustable, high style
- Suitable for moderate to high traffic applications
- Satin Chrome finish
- Mounting hardware included

**FALCON**® A division of  
Allegion Hardware.



S122 Wall Mount Door Stop



T218 Floor Mount Door Stop

411-418 ►



## STEP 4. GRAB A WEATHERSTRIP KIT

# SILL & WEATHERSTRIP KIT

## SILL AND WEATHERSTRIP KIT

Designed for exterior use single entry frames requiring high performance weatherstripping, sill and sweep.

### Kit Includes:

#### Sill

- Extruded aluminum
- 5" wide x 1/2" rise x 36" long
- Punched and countersunk for #10 Robertson flat head wood screw
- Wheelchair accessible
- UL Fire Labelled

#### Weatherstrip

- 1 set 1-36" & 2-84"
- Extruded aluminum c/w cold temperature vinyl insert.
- Actual size: 1-1/8" (28.7mm) wide.

#### Sweep

- 1 pc. 36" brush sweep
- Extruded aluminum clear anodized
- Actual size: 1-3/8" (28.7mm) high x 36" length.

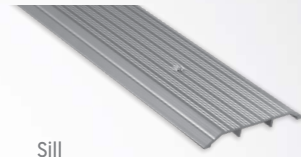

Sill



Weatherstrip



Sweep



# WELDED STEEL FRAMES

**Quick Ship!** All Madero Distribution Centres stock these products for immediate delivery.

## STANDARD WELDED FRAME



### Frame Specifications:

- 5-3/4" jamb depth; 3/0 x 7/0 and 3/0 x 6/8; left hand and right hand
- Existing wall anchors (can be used with pre-existing wood, steel stud or masonry walls)
- Both Regular arm and Parallel arm closer reinforcements
- 45 min manufacturer embossed FRR label

### Rough Opening Size Requirements:

- 3/0 x 6/8 = 40-1/4" x 80-1/8"
- 3/0 x 7/0 = 40-1/4" x 84-1/8"

### SKUS

Q-AS5 3/4 3/0X6/8 LH	Q-AS5 3/4 3/0X7/0 LH
Q-AS5 3/4 3/0X6/8 RH	Q-AS5 3/4 3/0X7/0 RH

## STANDARD WELDED FRAME with Deadlock Prep.



### Frame Specifications:

- 5-3/4" jamb depth; 3/0 x 7/0 and 3/0 x 6/8; left hand and right hand
- Existing wall anchors (can be used with pre-existing wood, steel stud or masonry walls)
- Both Regular arm and Parallel arm closer reinforcements
- Deadlock strike prep
- 45 min manufacturer embossed FRR label

### Rough Opening Size Requirements:

- 3/0 x 6/8 = 40-1/4" x 80-1/8"
- 3/0 x 7/0 = 40-1/4" x 84-1/8"

### SKUS

Q-AS5 3/4 3/0X6/8 DL	Q-AS5 3/4 3/0X7/0 DL
Q-AS5 3/4 3/0X6/8 DR	Q-AS5 3/4 3/0X7/0 DR





# DOUBLE DRILLED AND GLAZED HOLLOW METAL DOORS

**Quick Ship!** All Madero Distribution Centres stock these products for immediate delivery.

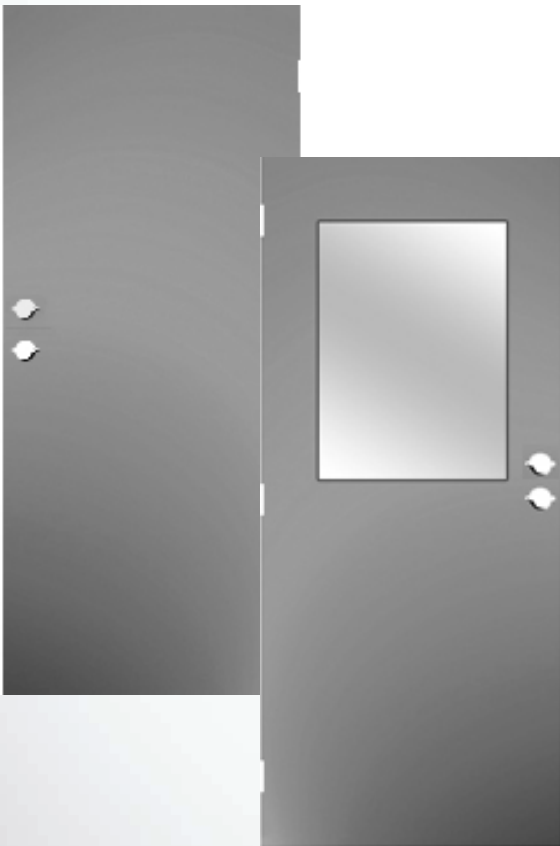

## DOUBLE DRILLED AND GLAZED COMMERCIAL STEEL DOORS

**Door Specifications:**

- 3/0 x 7/0 and 3/0 x 6/8; left hand and right hand
- Designed for exterior use in any commercial setting
- Polystyrene core (R7 Insulation Value)
- 20 gauge (HMIS20) or 18 gauge (HMIS)
- Machine prepped for 3 commercial hinges, and double drilled for lockset and deadbolt

## GLAZED STEEL DOORS

**Door Specifications:**

- Half lite glazing: 24" x 36" for 7/0 Doors, 24" x 32" for 6/8 Doors
- Sealed unit, dual pane, clear tempered glass

**SKUS**

Q-HMIS 3/0X6/8DL HL	HMIS20 3/0X6/8L DD
Q-HMIS 3/0X6/8DR HL	HMIS20 3/0X6/8R DD
Q-HMIS 3/0X7/0DL HL	HMIS20 3/0X7/0L DD
Q-HMIS 3/0X7/0DR HL	HMIS20 3/0X7/0R DD

**Nominal Size vs Actual Size:**

- 3/0 x 6/8 = 35-3/4" x 79-1/8"
- 3/0 x 7/0 = 35-3/4" x 83-1/8"



## ALUMINUM ENTRANCE PROGRAM

### ALUMINUM ENTRANCE

\*Shipped in retail friendly packaging.

#### Door Features:

- Door comes pre-glazed with sealed unit, clear tempered glass
- Door is pre-hung in an assembled thermally broken frame with standard hardware
- Options for interior and exterior use
- Durable and virtually maintenance free
- Maximum security hook bolt locks
- 1" diameter push/pulls included
- Mechanically fastened shear blocks and welded corner construction
- Adaptable to virtually all hardware
- Glass stops with bulb gaskets
- 1/4", 3/8", 5/8" and 1" glazing options available
- Adaptable to meet local building codes
- Ready to install
- Limited lifetime warranty



#### Standard Hardware:



PB - 21 Push Bar

CY-3 Thumb  
Turn and  
CY-1 Cylinder



BH-1  
Butt Hinge



Adams-Rite 1850 MS  
Hookbolt Lock and  
FB-1 Face Plate



PH-21 Offset  
Panic Pull



#### Specifications:

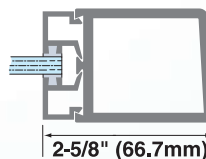

Series 212 - Narrow Stile

#### SKUS

Q-ALUM SGL CA NS LHO

Q-ALUM SGL CA NS RHO





## BULK COMMERCIAL HARDWARE

Buy in case lot quantities for additional discount!

### EXIT DEVICES AND TRIM

#### - Von Duprin 22 Series Exit Devices and Operating Trim

A quality product solution for medium to low traffic areas where proven reliability is needed.

#### - Stanley 300 Series Exit Devices and Operating Trim

A reliable and durable exit device for light duty commercial applications at a very economical price point.

**VON DUPRIN.**

**STANLEY.**



### LOCKSETS AND DEADBOLTS

#### - Schlage AL series Commercial Locksets

Designed to offer reliable security in medium to high traffic areas. With a Grade 2 rating, the AL Series suits any interior and exterior application.

#### - Falcon W series Commercial Locksets

A quality product at a great value price point. Ideal for low traffic commercial doorways and meets Grade 2 standard for durability.

**SCHLAGE**

**FALCON.**



### CLOSERS

#### - Falcon SC61 Medium Duty Closers

Designed for light to medium duty application such as small businesses or office buildings. Comes with a Grade 1 rating as well as UL listing.

#### - LCN 4040XP Heavy Duty Closers

LCN's most durable heavy duty closer, designed for the most demanding high traffic applications. Meets Grade 1 standards and boasts a 30 year limited warranty.



**FALCON.**

**LCN.**





## WEATHERSTRIP AND SEALS

### - Pemko

Since 1952 Pemko has been a key North American manufacturer of commercial weatherstrip products, carrying full lines of thresholds, fire/smoke seals, door bottoms, perimeter gasketing, sweeps and astragals.

### - KN Crowder

A manufacturer with a reputation for quality products, KN Crowder Auto Door bottoms are among the best in the industry.



## ACCESSORIES

Madero stocks a wide range of commercial opening accessories, including Flushbolts, Latch Guards, Kick Plates, Overhead Stops, Door Viewers, Push Plates and Door Pulls. We're proud to work with strong value driven vendors such as Ives, Glyn Johnson, Standard Metal, and more in this category of products.



## ACCESS DOORS

Cendrex manufactures a full line of Access Doors, Roof hatches and Floor Hatches to meet any job requirement from residential to commercial to industrial.

### - Flexi-snap Access Panels

A revolution in Access Door design! Made exclusively by Cendrex, these Access Panels are manufactured to the highest standard and are designed to not only look great but significantly reduce labour for installations!





## MADERO COMMERCIAL PROJECTS SERVICES

### OUR SERVICES

Madero Commercial Services offers full Estimating and Project Management services for door, hardware and building specialty requirements of all sizes of commercial, multi-family, industrial, and institutional construction projects. We are fully bonded and COR certified.

Additionally we can provide services for full blue print take-offs, site measuring, specification writing, design consultation, trouble shooting, custom metal fabrication, and complete installation of the products we provide. Our team of skilled professionals is available to provide complete solutions to the challenges of today's door and hardware industry.

### OUR AREAS OF EXPERTISE

- Hollow Metal Doors and Frames
- Wood Doors
- Aluminum Entrances
- Architectural Hardware
- Access Control Systems
- Automatic Operators
- Access Panels & Roof Hatches
- Washroom Accessories
- Toilet Partitions
- Lockers
- Mailboxes
- Operable Walls
- Specialty Doors (Crash doors, Cooler doors, Folding Doors)





---

## OUR VENDOR PARTNERS

Madero Commercial is proud to work with leading manufacturers in the Door, Hardware and Building Specialties Industry. The long lasting relationships we have with our vendors is vital to our success.

These partnerships include:

Allegion, Masonite, Richersons, Daybar, Assa Abloy, K.N. Crowder, Taymor, Baillargeon, Standard Metal, Stanley, DormaKaba, Canaropa, Lawrence, Hagar, Hadrian, Dyson, Frost, Bobrick, Old Castle Building Envelope, Cendrex, Coreflex



**ASSA ABLOY**



**DAYBAR**

## CONTACT INFORMATION

**Email:** [Estimating@westfour.ca](mailto:Estimating@westfour.ca)

All commercial quote requests can be sent to this email address. Please include as much information as possible, full plans and spec's if available.

**Phone:** 1-800-667-6977 (Press 2 for Commercial Inquiries)





**madero.ca**

Visit [madero.ca](https://madero.ca) to access our e-commerce site to discover all of the available commercial products (doors, frames, hardware and building specialties) that Madero can supply you with for your next commercial project!

## BEFORE YOU START

Where is this door going? \_\_\_\_\_

Traffic Usage: ☐ Low ☐ Medium ☐ High

Is it a Fire Rated Opening? ☐ Yes ☐ No



**Madero**  
Doors & Hardware

## ORDERING CHECKLIST

for

## COMMERCIAL

Doors & Hardware

### STEP 1. CHOOSE YOUR FRAME

#### 3 Pc, Knockdown Frames:

##### 18 Gauge

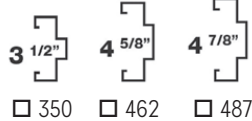

##### 16 Gauge

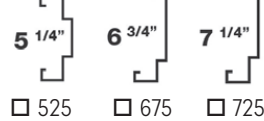

#### Welded Frames - 16 Gauge: (Require Anchors)

##### Throat Size



#### Expandable Frames Field Adjustable for Walls:

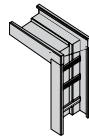

☐ **XF (REV)**  
4-1/2" to 7-7/8"

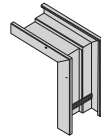

☐ **EF2**  
5-3/8" - 8-11/16"

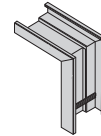

☐ **EF3**  
8-11/16" - 12"

#### Wall Anchors for Welded Frames:

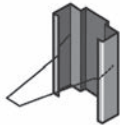

Masonry  
Wire Anchor  
(WA)  
☐



Steel  
Building  
Anchors  
(SBA)  
☐



Existing Wood  
Wall Anchor (EWA)  
☐  
Existing Masonry  
Wall Anchor (EMA)  
☐



Adjustable Stud  
Anchor - Wood  
or Steel Studs  
(Anchor A)  
☐



Masonry  
Tube Shim  
Anchor  
☐

### STEP 2. CHOOSE YOUR DOOR

#### Choose door width:

☐ 2' ☐ 2'4" ☐ 2'6" ☐ 2'8" ☐ 2'10" ☐ 3' ☐ 3'6" ☐ 4'

#### Choose door height:

☐ 6'8" ☐ 7'

#### Choose door gauge:

☐ 20 ☐ 18 ☐ 16

**Insulated** ☐ Yes ☐ No

**Double Drilled** ☐ Yes ☐ No

#### Standard Door Types:

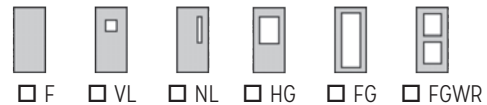

#### Handing of Door:



##### Right Hand (RH)

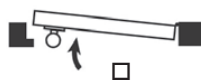

##### Left Hand (LH)



##### Right Hand Reverse (RHR)

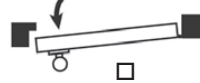

##### Left Hand Reverse (LHR)



#### Frame / Door / Hardware Configuration:

☐



Single Drill,  
Hinges

☐



Double Drill,  
Hinges

☐



Single Drill,  
Closer Prep,  
Hinges

☐



Exit Device,  
Closer, Hinges

☐



Single Drill, Lock,  
Closer, Flush Bolt,  
Hinges

☐



Exit Device, Closer,  
Removable Mullion,  
Hinges

### STEP 3. CHOOSE YOUR HARDWARE

- |  |                                      |                                      |                                      |   |
|--|--------------------------------------|--------------------------------------|--------------------------------------|---|
| <input type="checkbox"/> Keyed Lockset | <input type="checkbox"/> Deadbolt    | <input type="checkbox"/> Closer      | <input type="checkbox"/> Push Plate  | <input type="checkbox"/> Door Stop            |
| <input type="checkbox"/> Passage Set   | <input type="checkbox"/> Flushbolt   | <input type="checkbox"/> Check Chain | <input type="checkbox"/> Kick Plate  | <input type="checkbox"/> Weatherstrip / Sweep |
| <input type="checkbox"/> Privacy Set   | <input type="checkbox"/> Exit Device | <input type="checkbox"/> Door Pull   | <input type="checkbox"/> Door Viewer | <input type="checkbox"/> Threshold            |

Comments \_\_\_\_\_

Customer Signature: \_\_\_\_\_ Date: \_\_\_\_\_

Store Name or #: \_\_\_\_\_ Tag: \_\_\_\_\_ PO #: \_\_\_\_\_

Contact at Store: \_\_\_\_\_



Looking for a high quality, complete door and hardware package for your home? Madero offers a wide array of door designs and configurations with highly customizable glass and hardware options suitable for both interior and exterior applications.



Entry Series



Designer Entry Series



Garden Patio Doors



Multi-Family



Artisan Doors



Interior Doors

## Calgary

T 1.800.667.6977 • F 1.403.204.7665

## Saskatoon

T 1.800.667.6977 • F 1.306.934.7644

## Winnipeg

T 1.800.667.6977 • F 1.204.594.0201

**madero.ca**